



2750 SGD Door Handing Sheet

Company Name: _____

Job Address: _____

Lot #: _____

Super Name: _____

Super Email: _____

Super Cell: _____

Supervision: _____

Sell Price: _____

Handings (Check One)		Standard Sizes (Check One)	Rough Opening	Jamb Depth
XO	OX	59 1/2" x 95 1/2"	60" x 96"	5 15/16"
		71 1/2" x 95 1/2"	72" x 96"	5 15/16"
		95 1/2" x 95 1/2"	96" x 96"	5 15/16"
OXXO		116 3/4" x 95 1/2"	117 1/4" x 96"	5 15/16"
		140 3/4" x 95 1/2"	141 1/4" x 96"	5 15/16"
		188 3/4" x 95 1/2"	189 1/4" x 96"	5 15/16"
XXO	OXX	104 1/2" x 95 1/2"	105" x 96"	7 11/16"
		140 1/2" x 95 1/2"	141" x 96"	7 11/16"
XXXO	OXXX	137 3/4" x 95 1/2"	138 1/4" x 96"	10 3/16"
		185 3/4" x 95 1/2"	186 1/4" x 96"	10 3/16"

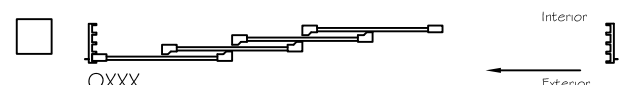
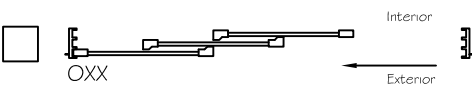
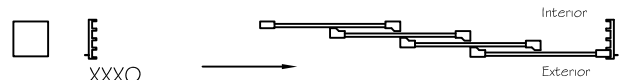
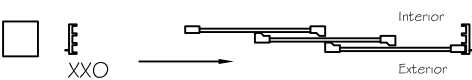
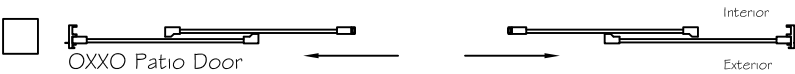
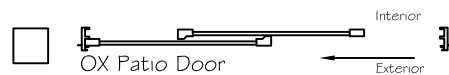
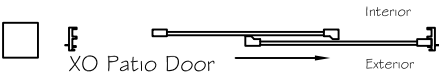

Custom Size: _____ Net Frame: Width _____ Height _____

Vinyl Sash: 2750

- Exterior Color: White Beige Other _____
- Interior Color: White Beige Other _____
- Frame Style: Block 1" Nail-Fin 1 3/8" Nail-Fin Retro Fin
- Sill Color: Clear Anodized Commercial Bronze
- Standard Handle: White Beige
- Signature Series (Upgrade): Flush (Standard with Multi Slide) Signature (Standard with 2 Track Slider)
- Handle Set Finish: White Brushed Chrome Black
- Escutcheon (Plate): No-Keyed Keyed
- Glass: 366 Other _____
- Screen: Yes None

Signature: _____ Date: _____